

5 shelf bookcase with doors

ebony
style # BK5SHFWDEB
dpci # 249-14-0043

espresso
style # BK5SHFWDES
dpci # 249-14-0042

rustic
style # BK5SHFWDBR
dpci # 249-14-1413

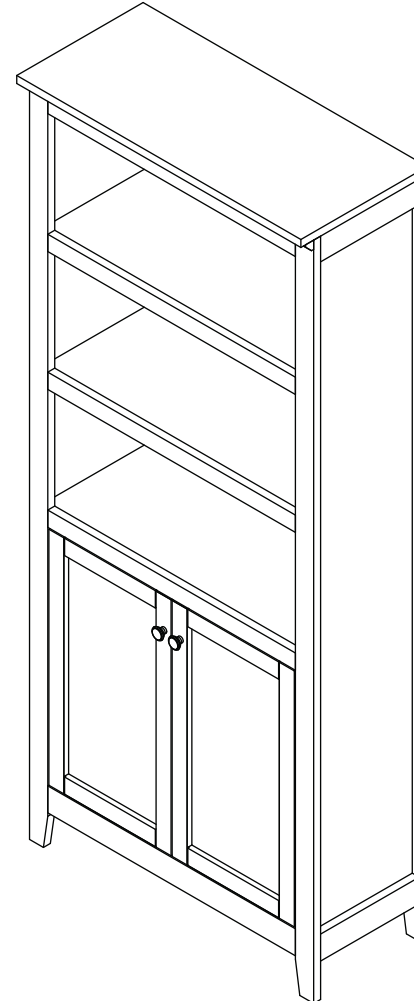

>> assembly instructions



Congratulations on your latest Target purchase.

Now what? Don't start sweating over this box of parts. This will be easy. We did the hard work for you. All you need to do is follow our simple instructions and you'll be on your way to transforming your room in no time. Good luck—though we're confident you won't need it.

before you begin

1. Check for damaged or missing parts. Call 1-855-MYTGTHOME (855-698-4846) for parts and service.
2. Use the carton as a working surface to prevent product damage during assembly.
3. Gather all tools prior to assembly.

tools required

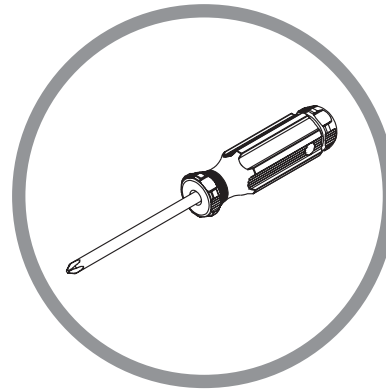
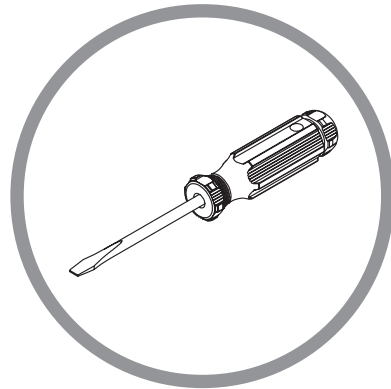
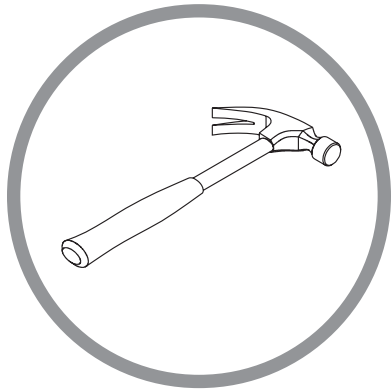

table of contents

.....

introduction	2
hardware	4
parts list	5
how to use the cam lock system	6
assembly	7-17

hardware

(H1) x 31
wooden dowel

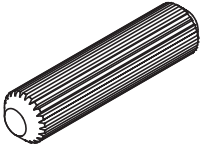

(H2) x 25
cam bolt

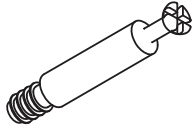

(H3) x 25
cam

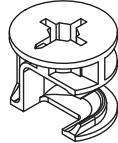

(H4) x 4
1" flat-head screw

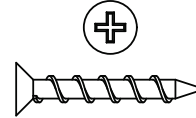

(H5) x 45
5/8" pan-head screw

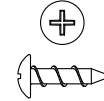

(H6) x 12
shelf support

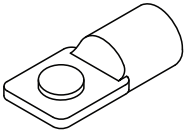

(H7) x 2
knob

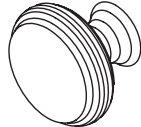

(H8) x 2
knob bolt



(H9) x 8
short flat-head screw

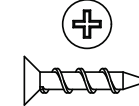

(H10) x 1
19mm pan head screw

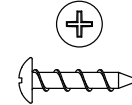

(H11) x 1
wall strap



(H12) x 2
5/8" washer

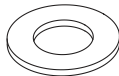

(H13) x 1
wall anchor

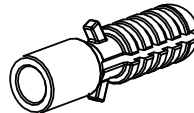

(H14) x 1
38mm wall screw

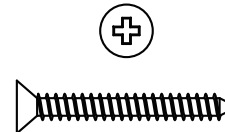

ITEM	DESCRIPTION	QUANTITY
------	-------------	----------

Z	top panel	1
Y	left side panel	1
X	right side panel	1
W	adjustable shelf	2
V	bottom panel	1
U	middle fixed shelf	1
T	middle fixed back rail	1
S	inner adjustable shelf	1
R	middle fixed front rail	1
Q	left door	1
P	right door	1
K2	lower back panel	1
K	back panel	1
J	decorative molding	1
I	top front rail	1
H	bottom front rail	1
E	adjustable shelf rail	2

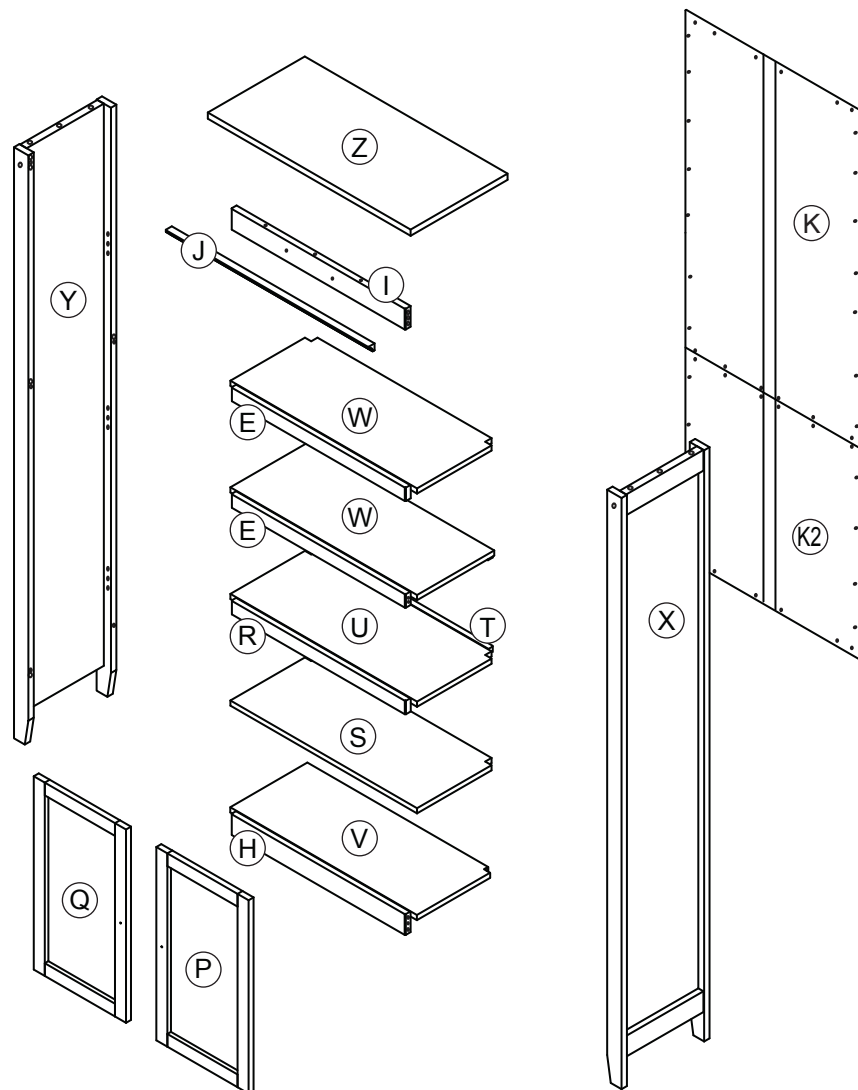

how to use the cam lock system

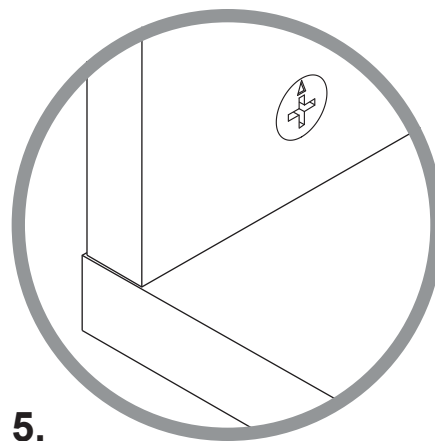
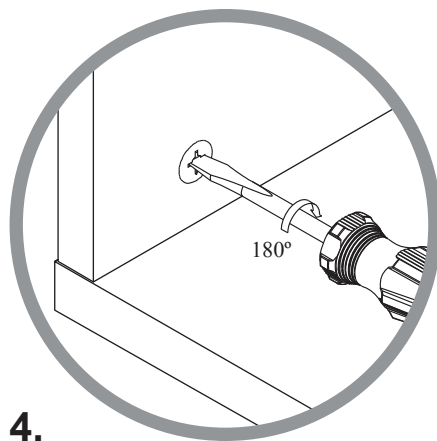
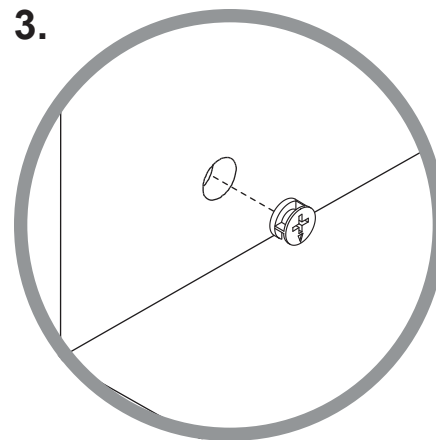
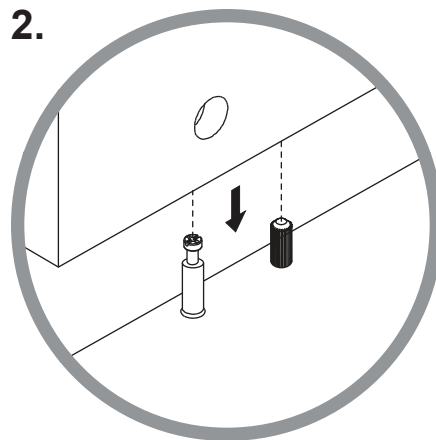
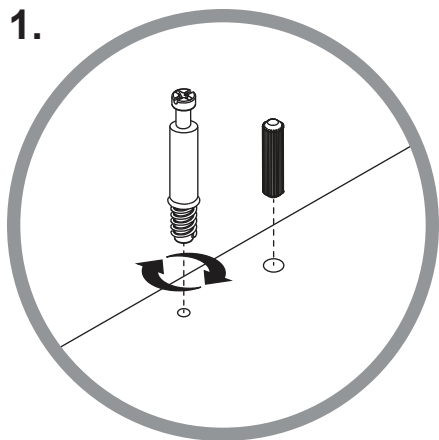

step 1.

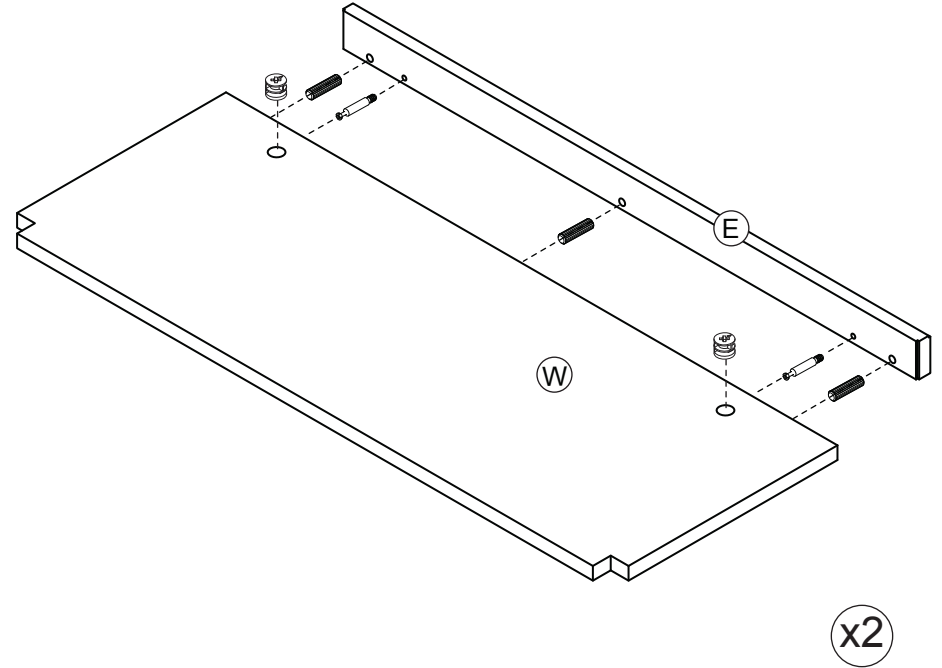
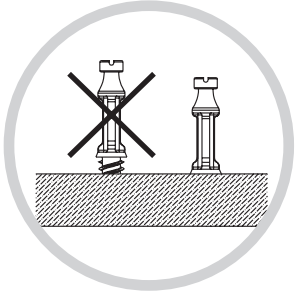

(H1) x 6
wooden dowel

(H2) x 4
cam bolt

(H3) x 4
cam

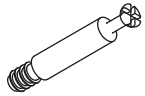
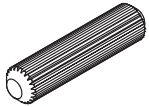

1. Carefully tap small wooden dowels into place. Leave 1/2" of the dowels sticking out.
2. Screw-In cam bolts must be screwed down flush with wood panel.
3. Refer to page 6 for instructions on how to use the cam lock system.

step 2.

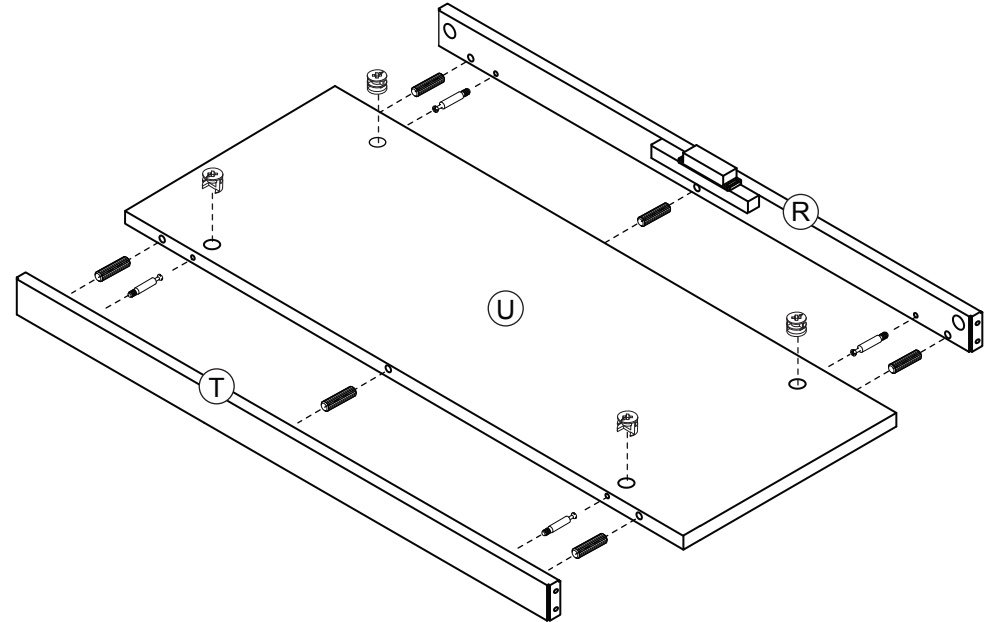

(H1) x 6
wooden dowel

(H2) x 4
cam bolt

(H3) x 4
cam

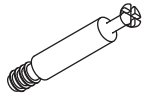
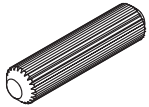

1. Carefully tap small wooden dowels into place. Leave 1/2" of the dowels sticking out.
2. Screw-In cam bolts must be screwed down flush with wood panel.
3. Refer to page 6 for instructions on how to use the cam lock system.

step 3.

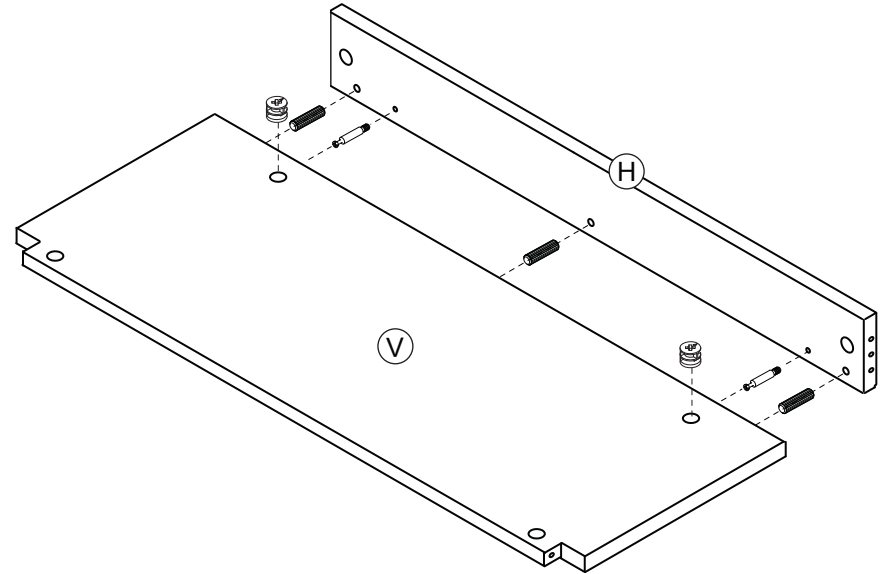

(H1) x 3
wooden dowel

(H2) x 2
cam bolt

(H3) x 2
cam

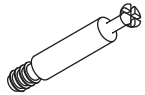
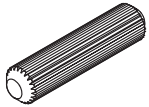

1. Carefully tap small wooden dowels into place. Leave 1/2" of the dowels sticking out.
2. Screw-In cam bolts must be screwed down flush with wood panel.
3. Refer to page 6 for instructions on how to use the cam lock system.

step 4.

(H1) x 6
wooden dowel

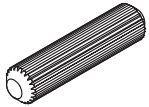

(H2) x 5
cam bolt

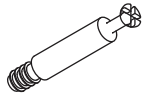

(H3) x 5
cam

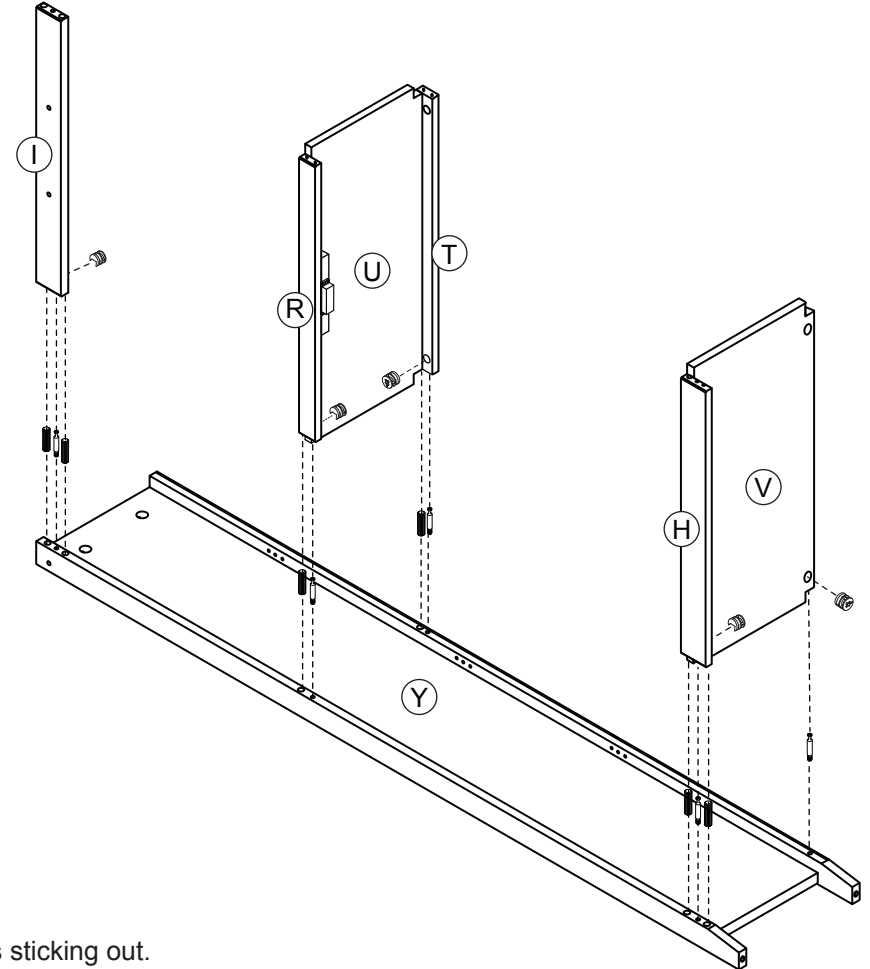

1. Carefully tap small wooden dowels into place. Leave 1/2" of the dowels sticking out.
2. Screw-In cam bolts must be screwed down flush with wood panel.
3. Refer to page 6 for instructions on how to use the cam lock system.

step 5.

(H1) x 6
wooden dowel

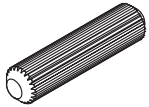

(H2) x 5
cam bolt

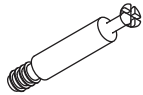

(H3) x 5
cam



1. Carefully tap small wooden dowels into place. Leave 1/2" of the dowels sticking out.
2. Screw-In cam bolts must be screwed down flush with wood panel.
3. Refer to page 6 for instructions on how to use the cam lock system.

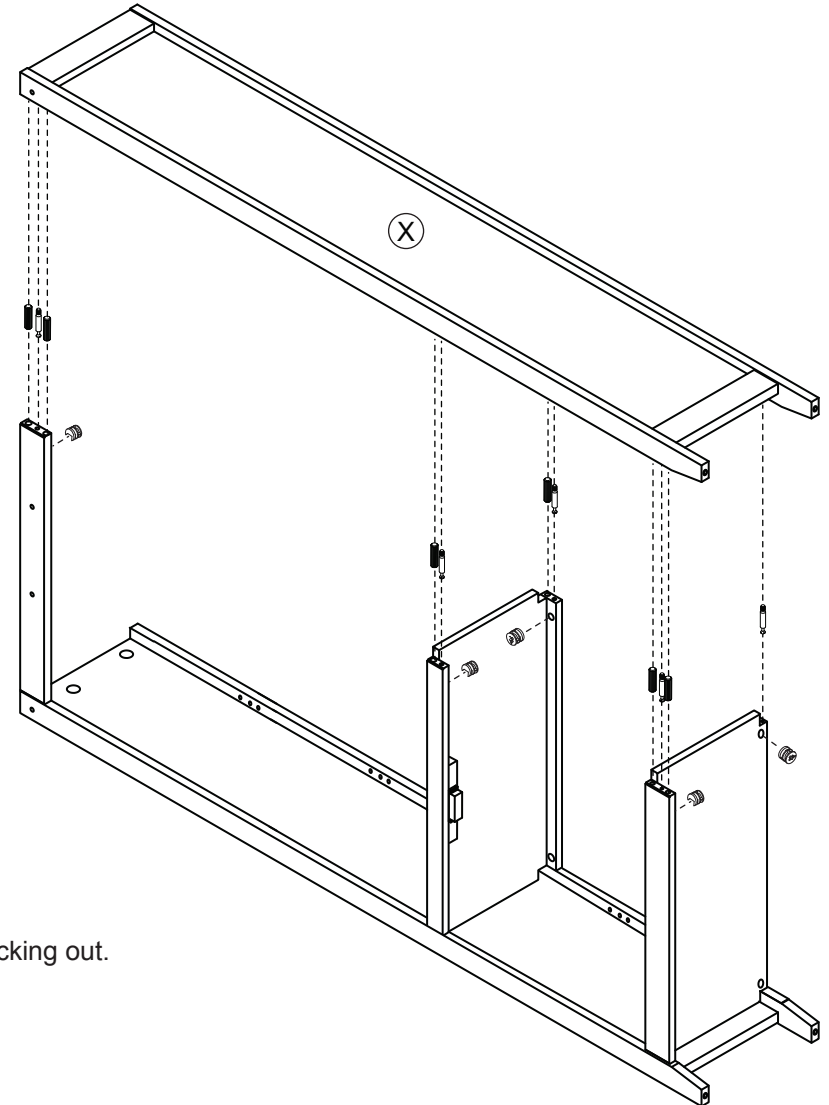

step 6.

(H4) x 4
1" flat-head screw

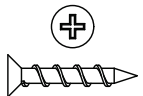

1. Do not over tighten screws.

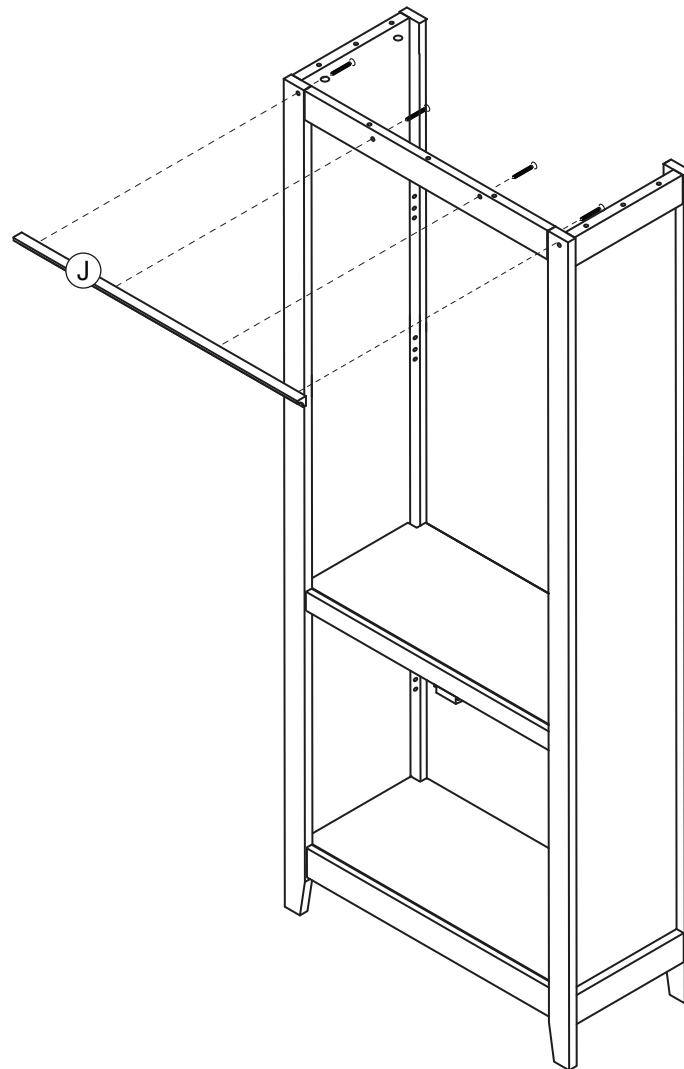

step 7.

(H1) x 4
wooden dowel

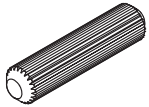

(H2) x 5
cam bolt

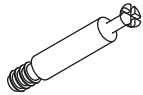

(H3) x 5
cam



1. Carefully tap small wooden dowels into place. Leave 1/2" of the dowels sticking out.
2. Screw-In cam bolts must be screwed down flush with wood panel.
3. Refer to page 6 for instructions on how to use the cam lock system.

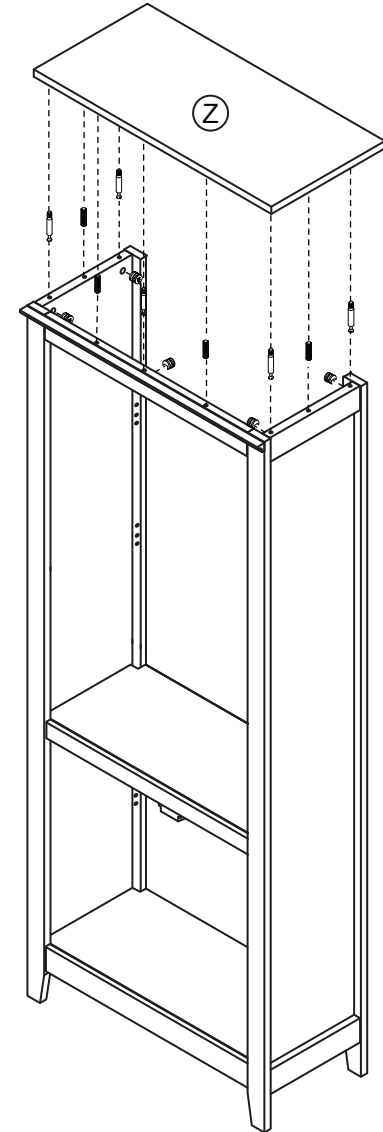

step 8.

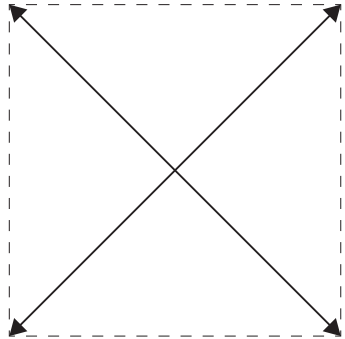

Begin by installing all of the screws along one edge of the back panel. Next, using a square or tape measure, make sure that the cabinet is square. (If using a tape measure, the distance from one corner, diagonally to the other corner should be the same in both directions.) Install the remaining screws, starting with the corners.

(H5) x 45

5/8" pan-head screw

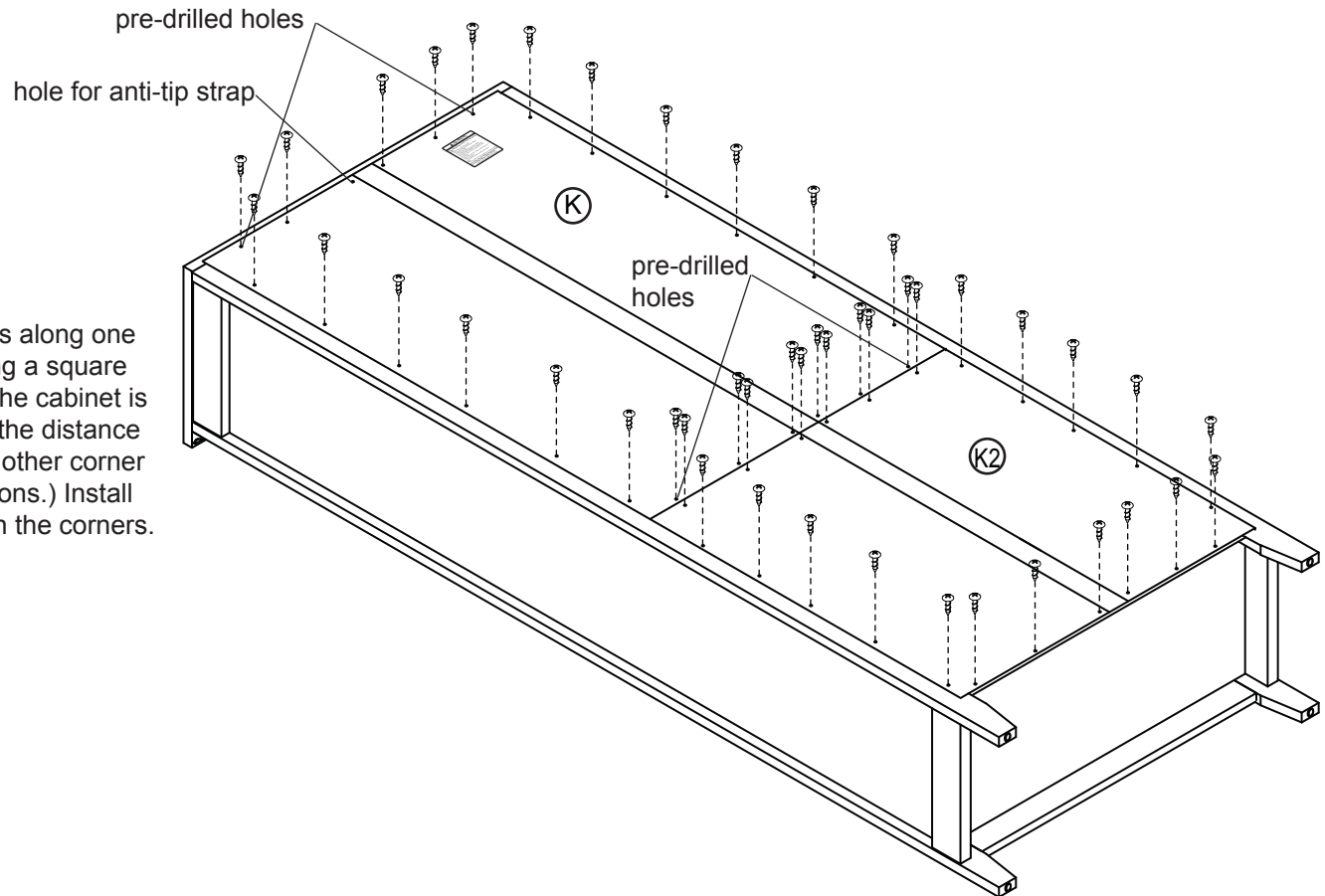

1. Make sure the screws go through the pre-drilled holes properly.
2. Do not over tighten screws.

step 9.

(H7) x 2
knob



(H8) x 2
knob bolt



(H9) x 8
short flat head
screw

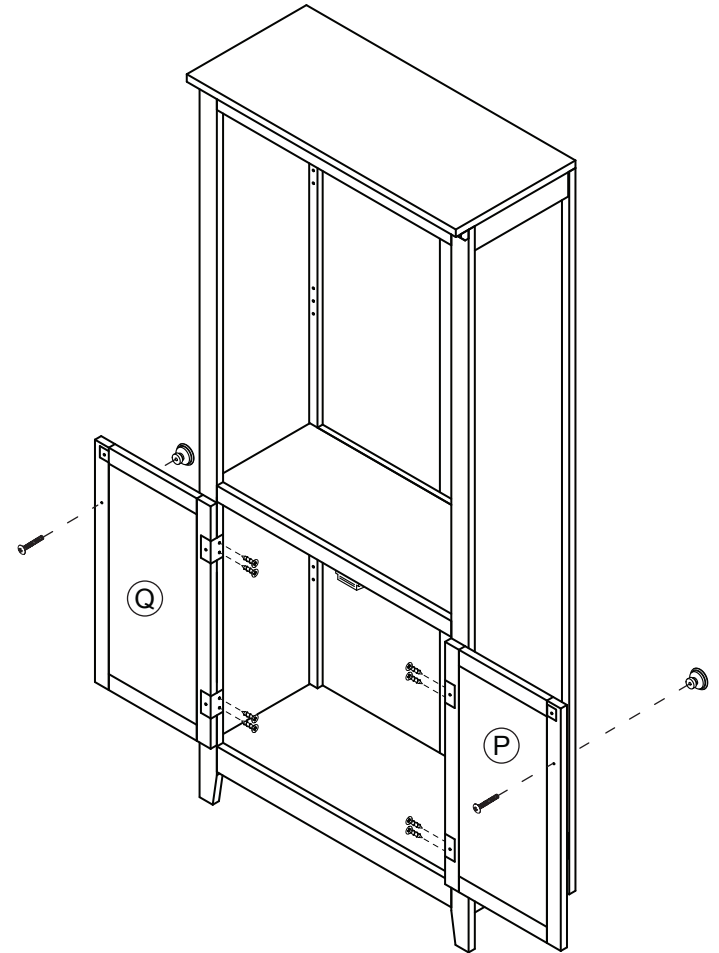

1. Do not over tighten bolts or screws

step 10.

(H6) x 12
shelf support



1. Insert shelf support into desired hole. Different holes accommodate different shelf heights
2. Angle shelf to fit between the rails and set on top of shelf supports.

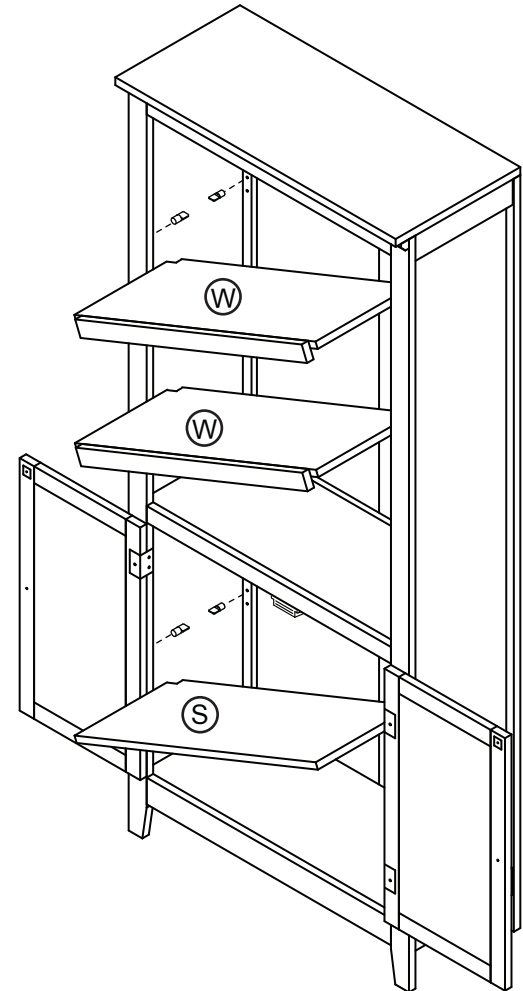

step 11.

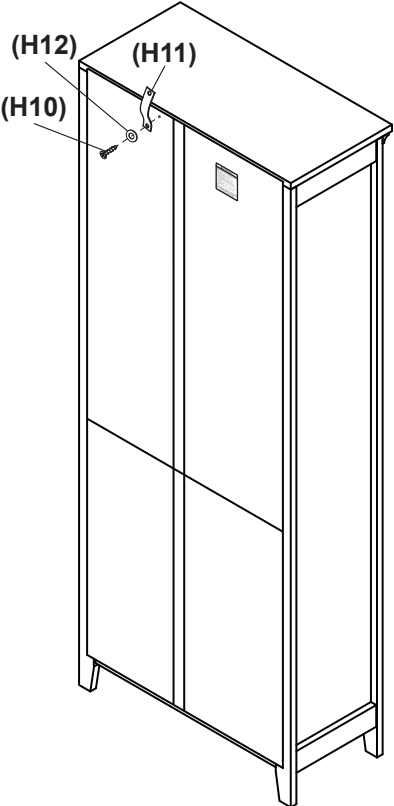

Position against wall

Mark position of strap hole on wall

Drill 1/4" hole

Tap in wall anchor

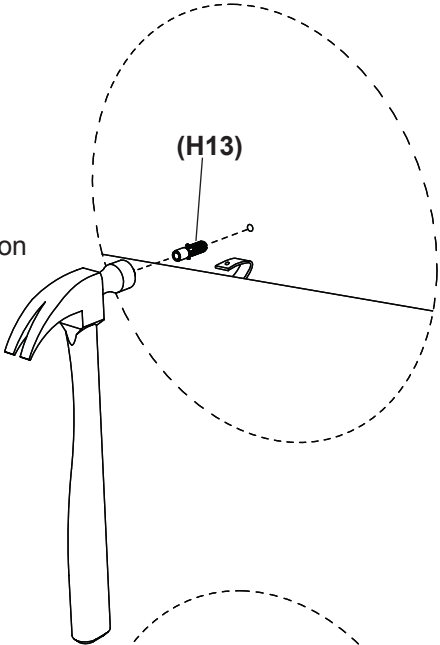

Fasten anti-tip strap with flat-head screw provided

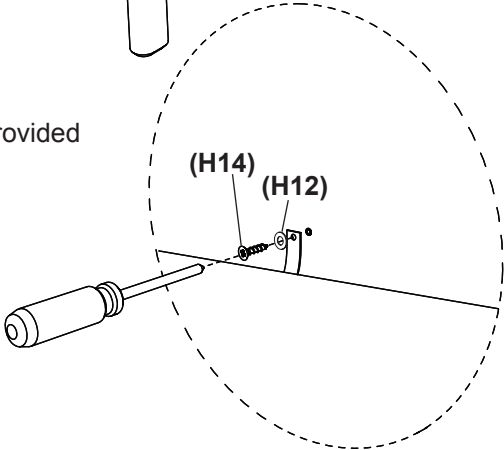

(H10) x 1

19mm pan head screw

(H11) x 1

wall strap

(H12) x 2

5/8" washer

(H13) x 1

wall anchor

(H14) x 1

38mm wall screw

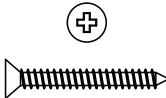
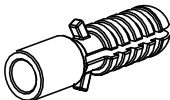
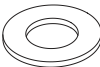
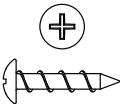

WARNING

Serious or fatal crushing injuries can occur from furniture tip-over. To help prevent tip-over:

- Install tip-over restraint provided.
- Place heavy items on lower shelves and as far back as possible.
- Place heaviest items in the lowest drawers.
- Unless specifically designed to accommodate, do not set TVs or other heavy objects on top of this product.
- Never allow children to climb or hang on drawers, doors, or shelves.
- Never open more than one drawer at a time.

(OR)

- Do not defeat or remove the drawer interlock system.

Use of tip-over restraints may only reduce, but not eliminate, the risk of tip-over.

This is a permanent label. Do not remove.

65 lbs
per shelf

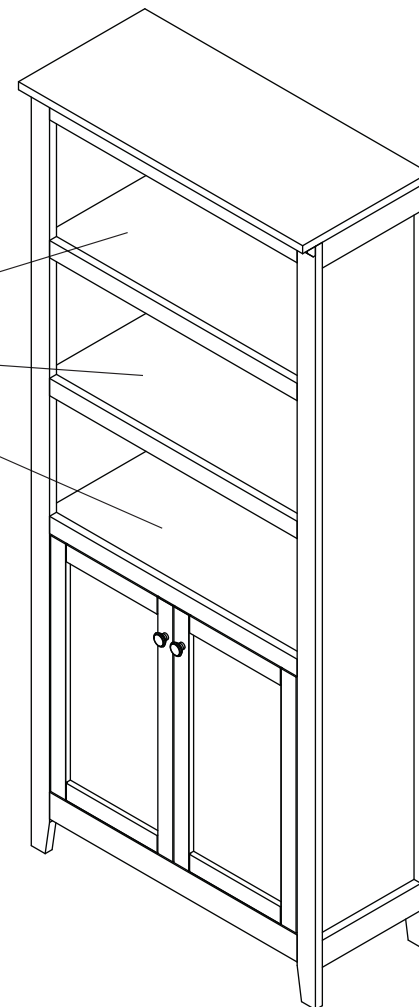

1. This unit has been designed for the weight shown. Exceeding this recommended weight could result in excessive “sagging” of the top. Extreme overloading can cause failure of the top and possible injury.
2. Furniture Care Instructions: Dust with a clean, lint-free cloth. Use a spray furniture polish as needed.

