

# GET STARTED

## QUICK START GUIDE

In a few easy steps you'll be on your way to enjoying something delicious!  
For complete instructions and videos, go online to [KitchenAid.com/Quickstart](http://KitchenAid.com/Quickstart).

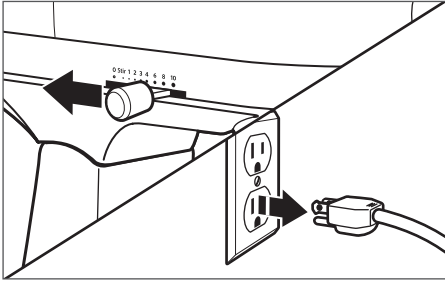

- 1. Check to be sure that the Stand Mixer is unplugged and the speed control is turned to "0".**  
**NOTE:** To move the speed control lever with ease, lift slightly up as you move it across the settings in either direction.

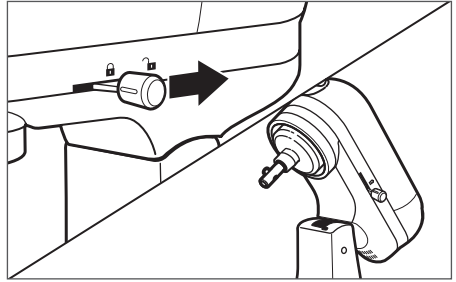

- 2. Raise the motor head:** Slide the locking lever to the unlock position and lift the motor head. Once lifted, ensure the locking lever is in the lock position to keep the motor head up.

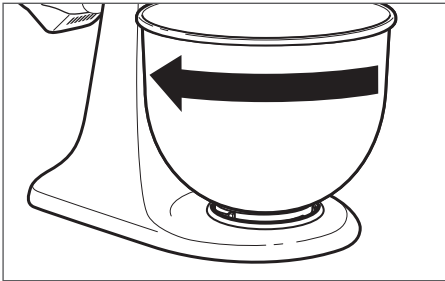

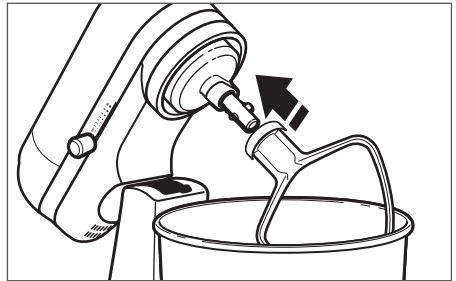

- 3. Attach the bowl:** Place the bowl on the bowl clamping plate and gently turn it in a clockwise direction to lock it into place.

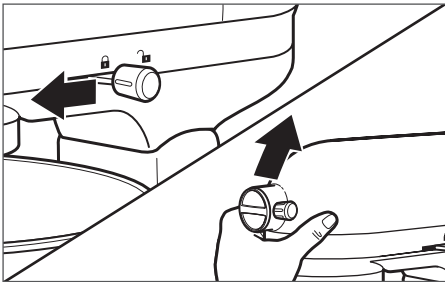

- 4. Attach any accessory:** Slip the accessory onto the beater shaft and press upward as far as possible. Turn the accessory counterclockwise to hook the accessory over the pin on the shaft.

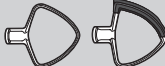

- 5. Lower the motor head:** Slide the locking lever to the unlock position and guide the motor head down. Make sure motor head is completely down, then slide the locking lever to the lock position. Before mixing, test lock by attempting to raise motor head.

ACCESSORY	USE TO MIX
FLAT BEATER* FLEX EDGE BEATER* 	Cookie dough, cake batter, guacamole, pulled meats
WIRE WHIP 	Whipped cream, egg whites, meringue
DOUGH HOOK 	Bread dough

\*Select models only and accessories sold separately