

Instant POD™

Multi-Pod Single Brew Coffee and Espresso Maker



User Manual

- 01** Get Started
- 02** Brew
- 03** Warranty and Contact Info



For more information and how-to videos,
visit instantappliances.com/instantpod

IMPORTANT SAFEGUARDS

(Yes, we have to)



At Instant Brands, your safety always comes first. Enjoy using your Instant coffee maker knowing it was designed to be quick, easy, and above all, safe.

As always, be cautious when using electrical appliances and follow basic safety precautions.

READ ALL INSTRUCTIONS, SAFEGUARDS AND WARNINGS BEFORE USE. FAILURE TO FOLLOW THESE SAFEGUARDS AND INSTRUCTIONS MAY RESULT IN INJURY AND/OR PROPERTY DAMAGE.

- 01** For countertop use only. Always operate the appliance on a stable, non-combustible, level surface.
- 02** For household use only. Not for commercial use. **DO NOT** use the appliance for anything other than its intended use.
- 03** Make sure that your outlet voltage corresponds to the voltage stated on the rating label of the coffee maker.
- 04** To protect against fire, electric shock and injury to persons, **DO NOT** immerse the power cord, plug or the appliance in water or other liquid.
- 05** Unplug from outlet when not in use and before cleaning. Allow the appliance to cool before putting on or taking off parts, and before cleaning the appliance.
- 06** Regularly inspect the appliance and power cord. **DO NOT** operate the appliance if the power cord or plug is damaged, or after the appliance malfunctions or is dropped or damaged in any manner. For assistance, contact Customer Care by email at **support@instantappliances.com**, by chat at **instantappliances.com/#chat**, or by phone at **1-800-828-7280**.

WARNING

Read this manual carefully and completely and retain for future reference. Failure to adhere to safety instructions may result in serious injury or damage.

IMPORTANT SAFEGUARDS

- 07** DO NOT let the power cord hang over the edge of tables or counters, and DO NOT allow it to touch hot surfaces.
- 08** DO NOT place the appliance on or near a hot gas or electric burner, or in a heated oven.
- 09** Only fill the water tank with clean, cold water. Never fill the water tank with mineral water, milk or other liquids.
- 10** DO NOT let the coffee maker operate without water.
- 11** Some parts of the appliance become hot when in operation. DO NOT touch with bare hands. Follow instructions for safe use to avoid burns.
- 12** DO NOT insert finger into the pod inlets beneath the top cover, to avoid personal injury.
- 13** To disconnect, unplug from power source. To unplug, grasp the plug and pull from the outlet. Never pull from the power cord.
- 14** DO NOT use outdoors. DO NOT leave the appliance exposed to sun, wind, rain and/or snow.
- 15** Only operate and store the coffee maker above 0°C / 32°F.
- 16** DO NOT leave the appliance unattended when in use.
- 17** This appliance is NOT to be used by children or by persons with reduced physical, sensory or mental capabilities. Close supervision is necessary when any appliance is used near children and these individuals. Children should not play with this appliance.

WARNING

Read this manual carefully and completely and retain for future reference. Failure to adhere to safety instructions may result in serious injury or damage.

IMPORTANT SAFEGUARDS

- 18** The use of accessories not recommended by the manufacturer may result in fire, electric shock or injury to persons.
- 19** Only use pods intended for this appliance. If the pod does not fit, DO NOT force the pod into the appliance.
- 20** **⚠ WARNING:** There is extremely hot water in the pod inlet during the brew process. To avoid the risk of injury, DO NOT open the top cover during the brew process.
- 21** To reduce the risk of fire or electric shock, do not remove the bottom cover. No user-serviceable parts inside. Repair should be done by authorized service personnel only.
- 22** If a long detachable power-supply cord or extension cord is used:
 - The marked electrical rating of the detachable power-supply cord or extension cord should be at least as great as the electrical rating of the appliance;
 - The longer cord should be arranged so that it will not drape over the counter top or table top where it can be pulled on by children or tripped over.

SAVE THESE INSTRUCTIONS.

⚠ WARNING

Read this manual carefully and completely and retain for future reference. Failure to adhere to safety instructions may result in serious injury or damage.

IMPORTANT SAFEGUARDS

WARNING

To avoid injury, read and understand the instructions in this user manual before attempting to use this appliance.

WARNING

Electrical shock hazard.

- DO NOT use an adapter.
- DO NOT remove the bottom cover. No user-serviceable parts inside. Repair should be done by authorized service personnel only.

Failure to follow these instructions may result in electric shock and/or death.

WARNING

THE FAILURE TO FOLLOW ANY OF THE IMPORTANT SAFEGUARDS AND/OR THE INSTRUCTIONS FOR SAFE USE IS A MISUSE OF YOUR APPLIANCE THAT CAN VOID YOUR WARRANTY AND CREATE THE RISK OF SERIOUS INJURY.

Special cord set instructions

As per safety requirement, a short power supply cord (0.6 m to 0.9 m / 24" to 35") is provided to reduce the hazards resulting from grabbing, entanglement and tripping.

This appliance has a polarized plug and one blade is wider than the other. To reduce the risk of electrical shock, the plug is intended to fit into a polarized outlet only one way. If the plug does not fit fully into the outlet, reverse the plug. If it still does not fit, contact a qualified electrician.

DO NOT attempt to modify the plug in any way.

WARNING

Read this manual carefully and completely and retain for future reference. Failure to adhere to safety instructions may result in serious injury or damage.

Table of contents

Let's get started!.....6

 So, what's in the box?.....6

 Is something missing or damaged?6

Product, parts and accessories7

Control panel8

Initial setup9

Initial cleaning.....10

Brewing K-Cups.....12

Brewing espresso pods14

Brewing tips16

Care, cleaning and storage17

 Emptying the used pod container18







 Removing mineral deposits19

Troubleshooting21

Warranty22

Contact us.....24

Product specifications

					
Model: Multi-Pod 68 MB	68 oz (2 Ltr)	120 V~60 Hz	1500 W	lbs: 12.07 kg: 5.48	in: 16.2 L x 7.2 W x 13 H cm: 41.2 L x 18.2 W x 33 H

Let's get started!

So, what's in the box?

Before using your new coffee maker, make sure everything is present and accounted for.

Illustrations in this document are for reference only and may differ from the actual product. Always refer to the actual product.

- Instant Pod Multi-Pod Single Brew Coffee and Espresso Maker
- Drip tray and drip tray plate
- User manual

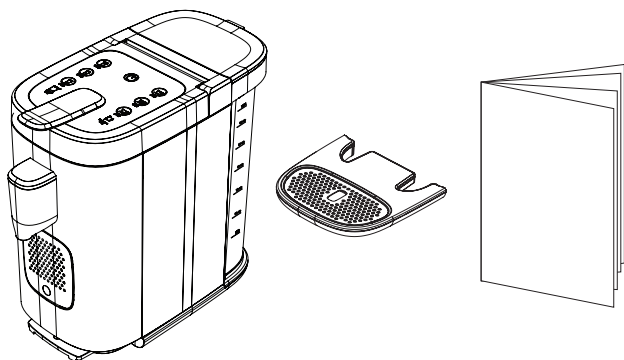

See **Product, parts and accessories** for a full parts breakdown.

For more information and how-to videos, visit instantappliances.com/instantpod.

Is something missing or damaged?

Get in touch with a Customer Care Advisor through our chat widget at instantappliances.com/#chat, by email at support@instantappliances.com or by phone at 1-800-828-7280.

Product, parts and accessories

Instant Pod Multi-pod Single Brew Coffee and Espresso Maker

Make sure everything is installed properly before use.

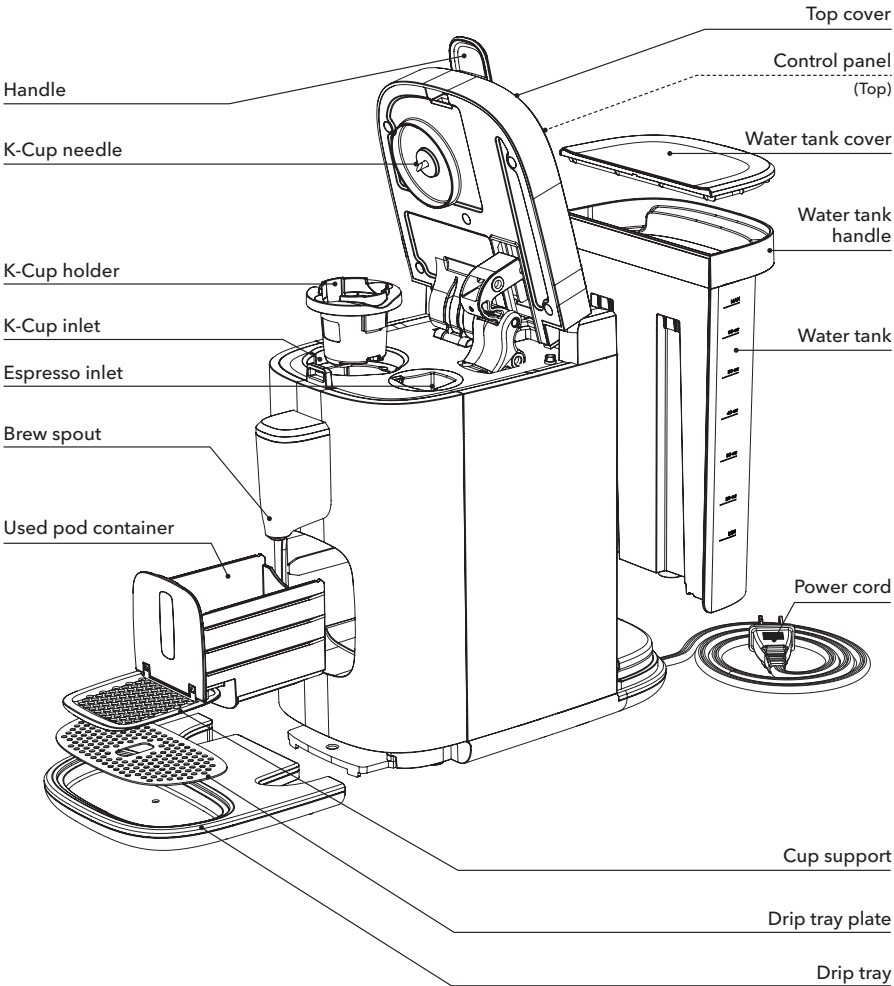

Illustrations in this document are for reference only and may differ from the actual product. Always refer to the actual product.

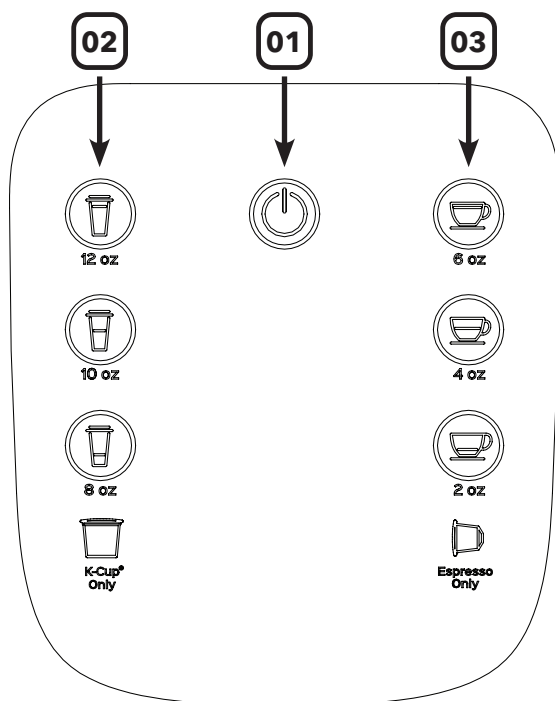

Control panel

The control panel of your Instant coffee maker is straightforward and super easy to use. If you haven't had your coffee yet, fear not! Your brew is seconds away.





01 Power on/off

02 K-Cup pod options

-  12 oz cup (355 mL)
-  10 oz cup (296 mL)
-  8 oz cup (237 mL)

03 Espresso pod options

-  6 oz cup (177 mL)
-  4 oz cup (118 mL)
-  2 oz cup (60 mL)

Illustrations in this document are for reference only and may differ from the actual product. Always refer to the actual product.

Initial setup

Coffee is always a good idea, so let's get this little guy going!

- 01 Pull your new coffee maker out of the box.
- 02 Remove all the material, adhesive strips and loose parts from in and around the appliance.
- 03 Place the coffee maker on a stable, level surface.
- 04 Lift off the water tank, then remove and discard the red plug. Place the water tank back on the base and press down to secure it.

 The sticker on the water tank may be removed.

- 05 Slide the drip tray into place beneath the front of the coffee maker

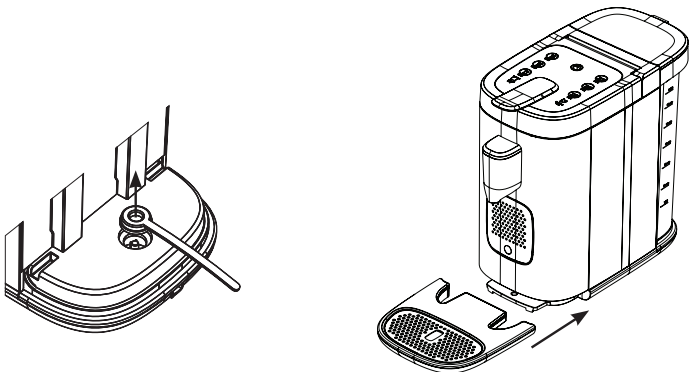

- 06 Follow the instructions in **Initial cleaning** before using the coffee maker for the first time.

 DO NOT remove safety warning stickers from the appliance.

⚠ CAUTION		
Read the Important Safeguards before using the appliance. Failure to read and follow those instructions for safe use may result in damage to the appliance, property damage or personal injury.	DO NOT place the appliance on a stovetop. Heat from an external source will damage the appliance.	DO NOT block the vents on the bottom of the appliance.

Initial cleaning

Before making your first piping hot cup, you must clean the coffee maker. To do so, run the following programs **without a pod in place**.

- 01** Lift the water tank upwards to remove it from the back of the coffee maker.

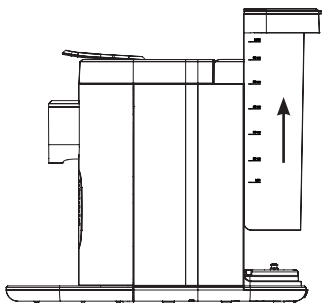

- 02** Clean the water tank with warm water and dish soap, then rinse it well with clean water.

- 03** Fill the water tank with cool, clean water to the **MAX** fill line as indicated on the water tank.

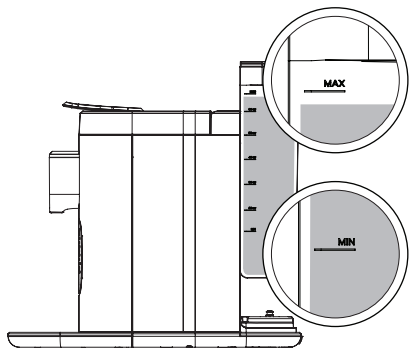

- 04** Align the water tank with the back of the coffee maker, then press down to secure it.



Instant Tip You can leave the water tank on the coffee maker and fill it with a cup or pitcher, or remove it to fill from your faucet or fridge – your choice!

- 05** Plug the power cord into a 120 V power source.

- 06** Use the handle to close the top cover.

- 07** Place a mug beneath the brew spout on the drip tray plate – make sure the mug is large enough to hold **8 oz / 237 mL** of water.

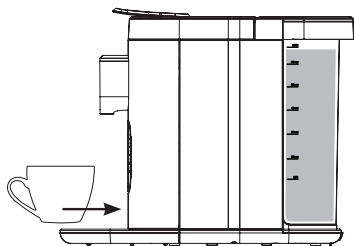

Initial cleaning

- 08** Touch the **power** key.
All of the keys illuminate.

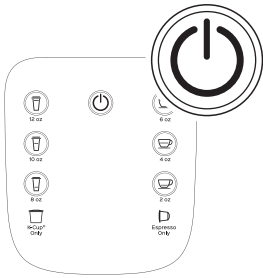

- 09** Touch **6 oz.** The key flashes as the water heats.



6 oz

- 10** The key illuminates when the coffee maker starts brewing, and soon hot water pours from the brew spout.

To **stop brewing** at any time, touch **6 oz** again.

When the water stops dripping, carefully discard the water in the mug.

- 11** Place the mug back onto the drip tray plate.

- 12** Touch **8 oz.**
The key flashes as the water heats.



8 oz

- 13** The key illuminates when the coffee maker starts brewing, and soon hot water pours from the brew spout.

To stop brewing at any time, touch **8 oz** again.

When the water stops dripping, discard the water in the mug. That's it! Brew away, friend.

⚠ CAUTION

Brewed liquid is **hot**. DO NOT place hands or unprotected skin beneath the brew spout while the coffee maker is brewing.

⚠ WARNING

DO NOT open the top cover while the coffee maker is brewing. Opening the top cover during operation may cause risk of personal injury and/or property damage.

Brewing K-Cups

Pick your favorite K-Cup, pop it in and in seconds you'll have a hot, steaming cup of delicious brew.

01 Fill the water tank with cool, clean water to between the **MIN** and **MAX** fill lines as indicated on the water tank.

02 Use the handle to open the top cover.



It must be fully open to properly receive pods.

03 If it is not already installed, insert the K-Cup holder into the K-Cup inlet.

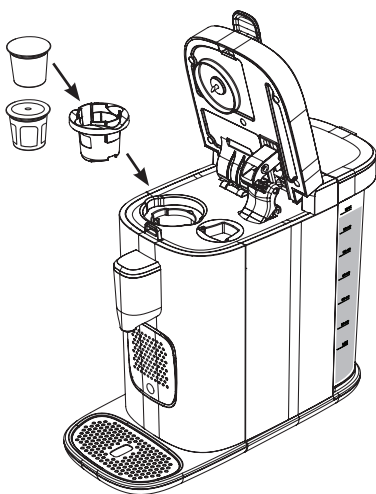

The coffee maker is only compatible with generic, universal reusable K-cups (for use with versions 1.0 AND 2.0).

04 Insert a K-Cup into the K-Cup holder.

05 Press the handle down to close the top cover.

06 Place your mug beneath the brew spout on the drip tray plate, or if necessary, the entire drip tray can be removed to accommodate larger cups.

07 Touch the **power** key. All of the keys illuminate.

Brewing K-Cups

08 Touch **8 oz**, **10 oz**, or **12 oz** from the K-Cup section, depending on how much you want to brew.



12 oz



10 oz



8 oz

The key flashes as the water heats.



Although all cup sizes illuminate, if you select **2 oz**, **4 oz**, or **6 oz** while a **K-Cup is in place**, the coffee maker will only dispense water.

09 The key illuminates when the coffee maker starts brewing, and soon hot water pours from the brew spout.

To **stop brewing** at any time, touch the selected cup size key again.

10 When the water stops dripping, lift the handle to open the top cover.

11 Carefully remove the used K-Cup and discard it.
Easy, right? Enjoy!

NOTICE

DO NOT attempt to brew if the water level is below the **MIN** fill line as indicated on the water tank.

⚠ WARNING

DO NOT open the top cover while the coffee maker is in operation.

DO NOT touch the blade in the K-Cup holder when the top cover is up.

DO NOT touch the water outlet needle when the top cover is up.

Brewing espresso pods

There's a world of flavor packed into those itty-bitty espresso pods just waiting to be brewed out. The coffee maker is compatible with the original Nespresso-style capsules.

NOTICE

Before brewing your first cup from an espresso pod, follow the steps in the **Initial cleaning** to heat a cup of water without a pod in place.

01 Fill the water tank with cool, clean water to between the **MIN** and **MAX** fill lines as indicated on the water tank.

02 Use the handle to open the top cover.



It must be fully open to properly receive pods.

03 Insert the espresso pod on its side into the Espresso inlet.



Do not push down hard on the pod as it will go through to the used pod container.

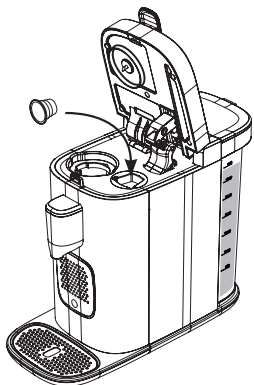

04 Press the handle down to close the top cover.

05 To brew **2 oz** or **4 oz**, fold down the cup support and place your mug on it.

To make **6 oz**, place your cup onto the drip tray plate.

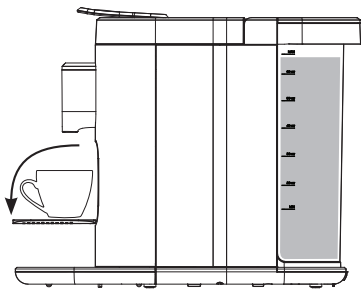

06 Touch the **power** key. All of the keys illuminate.



Brewing espresso pods

07 Touch **2 oz**, **4 oz**, or **6 oz** from the Espresso section, depending on how much coffee you want to brew.

The key flashes as the water heats.

 Although all cup sizes illuminate, if you select **8 oz**, **10 oz**, or **12 oz** while an **espresso pod is in place**, the coffee maker will only dispense water.



08 The key illuminates when the coffee maker starts brewing, and soon hot water pours from the brew spout.

To **stop brewing** at any time, touch the selected cup size key again.

09 When the water stops dripping, lift the handle to open the top cover.

The pod automatically drops into the used pod container.

Smells heavenly... enjoy!

NOTICE

DO NOT attempt to brew if the water level is below the **MIN** fill line as indicated on the water tank.

⚠ WARNING

DO NOT open the top cover while the coffee maker is in operation.

DO NOT touch the blade in the K-Cup holder when the top cover is up.

DO NOT touch the water outlet needle when the top cover is up.

Brewing tips

Follow these tips and tricks to make sure you’re treating yourself to the best cup possible.

For how-to videos and other tips, visit instantappliances.com/instantpod.

Tip	How to do it and why
Make stronger, or espresso-style coffee with your coffee maker.	Choose a smaller cup size to brew a stronger cup.
Make coffee with an espresso pod.	Choose a larger cup size to brew a weaker cup, or, brew a regular espresso, then add water to make it an Americano.
Always use fresh filtered water.	<p>The better the quality of your water, the better tasting your coffee will be!</p> <p>Using filtered water can also help to reduce mineral deposits from accumulating in the coffee maker.</p>
Pre-heat the coffee maker.	<p>If your coffee maker cools between brewing sessions, you may not be getting the best possible flavor. Heat up the coffee maker’s internal components to improve the taste of your next cup.</p> <p>To do so, run your desired brewing program without a pod inserted, discard the water, then brew as normal!</p>
Recycle or compost single serve pods.	<p>If you purchase biodegradable pods, the entire pod can be added to a composter.</p> <p>Plastic pods can be recycled if you remove the coffee grounds first.</p> <p>Used coffee grounds can be added to soil to enrich garden beds!</p>
Rinse your K-Cup holder, and/or clean the inlets after brewing.	Residue can alter the taste of your brew. Follow Care, cleaning and storage instructions to clean your inlets and K-Cup holder after using the coffee maker, or, simply run a brew program without a pod installed to rinse the appliance.
Descale and clean your coffee maker frequently.	See Removing mineral deposits for descaling instructions.

Care, cleaning and storage

Clean your Instant Pod regularly to ensure the best possible flavor, and to prevent scale build-up.

Always unplug the coffee maker and let it cool to room temperature before cleaning. Clean with a damp cloth and wipe dry – never use metal scouring pads, abrasive powders or harsh chemical detergents on any of the coffee maker’s parts.

Let all parts dry thoroughly before use, and before storage.

Parts	Cleaning methods and instruction
K-Cup holder	Remove from the coffee maker before cleaning.
Water tank	The water tank is removable for cleaning.
Cup support	The cup support and attached used pod container are removable for cleaning.
Drip tray and drip tray plate	The drip tray and drip tray plate are removable from the coffee maker and come apart for cleaning.
Used pod container	Holds up to 10 used espresso pods at a time. Empty weekly, or more as needed. DO NOT allow pods to sit for longer than 7 days.
Coffee maker exterior	Clean as needed.
Power cord	Clean as needed. DO NOT fold the power cord when storing.

WARNING

The coffee maker contains electrical components. To avoid fire, electric shock or personal injury:

- HAND WASH ONLY.
- DO NOT rinse or immerse the coffee maker, power cord or plug in water or other liquids.
- DO NOT clean any of the parts or components in a dishwasher.

Care, cleaning and storage

Emptying the used pod container

The used pod container can be easily removed to empty and clean.

To remove it

- 01** Press on the indent and fold down the cup support.

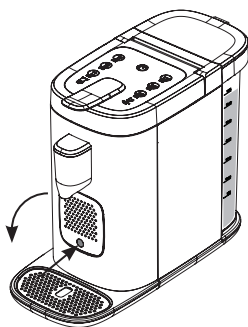

- 02** The cup support doubles as a handle. Use it to access the used pod container.
- 03** Remove the container from the coffee maker and empty it.

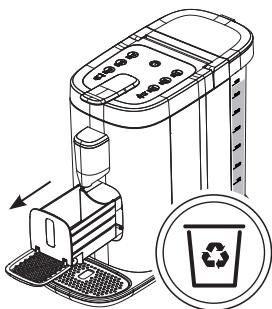

To install it

- 01** Insert the container into the opening on the coffee maker.
- 02** Push the container into place.
- 03** If desired, fold up the cup support, or brew a little espresso to congratulate yourself for a job well done!

Care, cleaning and storage

Removing mineral deposits

With regular use minerals may accumulate in the coffee maker, which can affect the temperature and strength of your brew.

To make sure your coffee maker stays in tip top shape, descale it regularly to keep minerals deposits from building up.

If you forget, don't worry! After 300 cycles, the 10 oz and 12 oz keys flash to remind you to descale your coffee maker.

Cleaner	Cleaner : Water Ratio
Household descaler	1 : 4
Citric acid	3 : 100

- 01** Combine cleaner and water as directed above.
- 02** Make sure the K-Cup holder is in place in the K-Cup inlet.
- 03** Fill the water tank to the **MAX** line with the cleaning mixture.
- 04** Place a large container beneath the drip nozzle. If necessary, remove the entire drip tray from the coffee maker.
- 05** Touch and hold the **10 oz** and **12 oz** keys for 3 seconds. The cleaning mixture runs through the appliance until the water tank is empty.
- 06** Discard the cleaning mixture and replace the container beneath the drip nozzle.
- 07** Fill the water tank to the **MAX** line with cool, clean water.
- 08** Touch and hold the **10 oz** and **12 oz** keys for 3 seconds. The water runs through the appliance until the water tank is empty.
- 09** Discard the water.

All done! Is it time for coffee yet?

CAUTION

Hot water is used for descaling. To avoid risk of scalding personal injury and/or property damage, the container must be large enough to hold the **entire contents of the water tank** (68 oz / 2000 mL).

Troubleshooting

Register your Instant Pod today at instantappliances.com/support/register.

Get in touch with a Customer Care Advisor through our chat widget at instantappliances.com/#chat, by email at support@instantappliances.com or by phone at 1-800-828-7280.

For more troubleshooting tips go to instantappliances.com/instantpod.

Resolution table

Problem	Possible reason	Try this
The key indicator light is not on, and/or the coffee maker will not work.	The appliance has been inactive for 30 minutes and has gone to sleep.	Touch the power key to wake the coffee maker.
	The power cord is not inserted into the outlet properly.	Inspect the power cord for damage. If damage is noticed, contact Customer Care . Check the outlet to ensure it is powered.
	The coffee maker's electrical fuse has blown.	Contact Customer Care .
The coffee maker makes a strange noise.	No water in the water tank.	Fill the water tank to between the MIN and MAX lines as indicated on the water tank.
All keys flash simultaneously.	Water tank is empty.	Touch any key to stop the alert. Fill the water tank to between the MIN and MAX lines as indicated on the water tank.
4 oz and 6 oz keys flash simultaneously.	Internal error.	Contact Customer Care .
10 oz and 12 oz keys flash simultaneously.	Time to descale your coffee maker.	Touch any key to stop the alert. Follow the instructions in Removing mineral deposits .

Any other servicing should be performed by an authorized service representative.

Warranty

Limited Warranty

This Limited Warranty is effective for one year from the date of original consumer purchase. Proof of original purchase date and, if requested by an authorized representative of Instant Brands Inc. ("Instant Brands"), return of your appliance, is required to obtain service under this Limited Warranty. Provided that this appliance is operated and maintained in accordance with written instructions attached to or furnished with the appliance, Instant Brands will, in its sole and exclusive discretion, either: (i) repair defects in materials or workmanship; or (ii) replace the appliance. In the event that your appliance is replaced, the Limited Warranty on the replacement appliance will expire 12 months from the date of original consumer purchase.

This Limited Warranty extends only to the original purchaser and use of the appliance in the United States of America and Canada. This warranty does not cover units that are used outside of the United States of America and Canada.

Any modification or attempted modification to your appliance may interfere with the safe operation of the appliance and will void this Limited Warranty. This Limited Warranty does not apply in respect of any appliance or any part thereof that has been altered or modified unless such alterations or modifications were expressly authorized by an Instant Brands representative.

Limitation and Exclusions

The liability of Instant Brands, if any, for any allegedly defective appliance or part shall in no circumstances exceed the purchase price of a comparable replacement appliance.

This Limited Warranty does not cover:

1. Damage resulting from accident, alteration, misuse, abuse, neglect, unreasonable use, use contrary to the operating instructions, normal wear and tear, commercial use, improper assembly, disassembly, failure to provide reasonable and necessary maintenance, fire, flood, acts of God or repair by anyone unless directed by an Instant Brands Representative;
2. Repairs where your appliance is used for other than normal, personal use or when it is used in a manner that is contrary to published user or operator instructions; or
3. Use of unauthorized parts and accessories, or repairs to parts and systems resulting from unauthorized repairs or modifications made to this appliance.

The cost of repair or replacement under these excluded circumstances shall be paid by you.

Warranty

Disclaimer of Implied Warranties

EXCEPT AS EXPRESSLY PROVIDED HEREIN AND TO THE EXTENT PERMITTED BY LAW, INSTANT BRANDS MAKES NO WARRANTIES, CONDITIONS OR REPRESENTATIONS, EXPRESS OR IMPLIED, BY STATUTE, USAGE, CUSTOM OF TRADE OR OTHERWISE WITH RESPECT TO THE APPLIANCES OR PARTS COVERED BY THIS WARRANTY, INCLUDING BUT NOT LIMITED TO, WARRANTIES, CONDITIONS, OR REPRESENTATIONS OF WORKMANSHIP, MERCHANTABILITY, MERCHANTABLE QUALITY, FITNESS FOR A PARTICULAR PURPOSE OR DURABILITY.

Some states or provinces do not allow for the exclusion of implied warranties of merchantability or fitness, so this limitation may not apply to you. In these states and provinces, you have only the implied warranties that are expressly required to be provided in accordance with applicable law.

Limitation of Remedies; Exclusion of Incidental and Consequential Damage

YOUR SOLE AND EXCLUSIVE REMEDY UNDER THIS LIMITED WARRANTY SHALL BE APPLIANCE REPAIR OR REPLACEMENT AS PROVIDED HEREIN. INSTANT BRANDS SHALL NOT BE LIABLE FOR INDIRECT, INCIDENTAL OR CONSEQUENTIAL DAMAGES ARISING OUT OF OR IN CONNECTION WITH THE USE OR PERFORMANCE OF THE APPLIANCE OR DAMAGES WITH RESPECT TO ANY ECONOMIC LOSS, PERSONAL INJURY, LOSS OF PROPERTY, LOSS OF REVENUES OR PROFITS, LOSS OF ENJOYMENT OR USE, COSTS OF REMOVAL, INSTALLATION OR OTHER INDIRECT, INCIDENTAL OR CONSEQUENTIAL DAMAGES OF ANY NATURE OR KIND.

Warranty Registration

Please visit **www.instantappliances.com/support/register** to register your new Instant Brands™ appliance and validate your warranty within thirty (30) days of purchase. You will be asked to provide the store name, date of purchase, model number (found on the back of your appliance) and serial number (found on the bottom of your appliance) along with your name and email address. The registration will enable us to keep you up to date with product developments, recipes and contact you in the unlikely event of a product safety notification. By registering, you acknowledge that you have read and understand the instructions for use, and warnings set forth in the accompanying instructions.

Warranty Service

To obtain service under this warranty, please contact our Customer Service Department by phone at **1-800-828-7280** or by **email to support@instantappliances.com**. You can also create a support ticket online at **www.instantappliances.com/support**. If we are unable to resolve the problem, you may be asked to send your appliance to the Service Department for quality inspection. Instant Brands is not responsible for shipping costs related to warranty service, save and except for shipping costs associated with the return of your appliance from Canada or within the 48 contiguous states and the District of Columbia of the United States of America, as provided herein. When returning your appliance, please include your name, mailing address, email address, phone number, and proof of the original purchase date as well as a description of the problem you are encountering with the appliance.

Instant™

Instant Brands Inc.

11-300 Earl Grey Dr., Suite 383
Ottawa, Ontario
K2T 1C1
Canada

Register your product today

instantappliances.com/support/register

Contact us

1-800-828-7280
support@instantappliances.com
instantappliances.com/#Chat



instantappliances.com
store.instantpot.com

